



College Code:7Q

BRILLIANT GRAMMAR SCHOOL EDUCATIONAL SOCIETY'S GROUP OF INSTITUTIONS - INTEGRATED CAMPUS



(Sponsored by Brilliant Grammar School Educational Society)

(Approved by A.I.C.T.E., & P.C.I., New Delhi, Affiliated to JNTUH, Hyderabad)

(Accredited by "NAAC" with "A" Grade)

Abdullapur (V), Abdullapurmet (M), R.R.Dist., Hyderabad - 501 505. Ph: 08415-201007

Website : www.bgiic.ac.in, E-mail: principal@bgiic.ac.in Cell: 9442263457

Date: 15.04.2024

TO WHOMEVER IT MAY CONCERN

I, Kasireddy Narayan Reddy , Secretary , Brilliant grammar school Educational Society's Group of Institutions -Integrated Campus is hereby stating that, the River/ Canals/Rail Tracks/Highways/ High Tension line or any other such entity are not passing through the Site, this is for your kind Information.

SECRETARY
Brilliant Grammar School
Educational Society's Group of
Institutions-Integrated Camps
Abdullapur (V), Abdullapurmet (M),
R.R. Dist-501505.

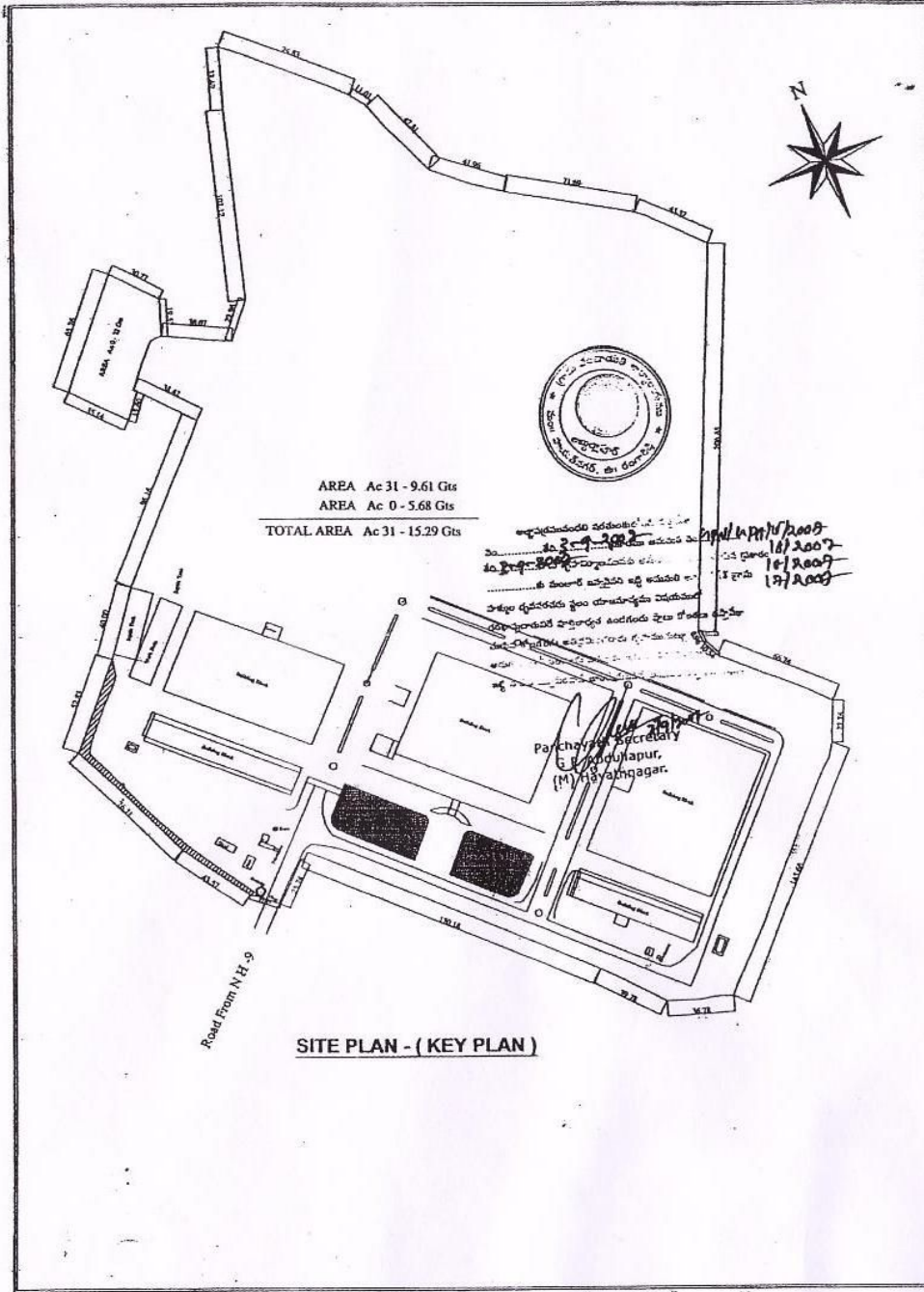

SITE PLAN SHOWING THE EXISTING EDUCATIONAL BUILDING IN SY. NO'S 48 & 49, 41, 49, 50 & 51, 41, 47, 48, 49, 50 & 51 SITUATED AT : ABDULLAPUR (V), ABDULLAPURMET (M), RANGA REDDY DIST. T.S

BELONGS TO: **BRILLIANT GROUP OF TECHNICAL INSTITUTIONS**
 (SPONSORED BY **BRILLIANT GRAMMAR SCHOOL EDUCATIONAL SOCIETY**)

1) **M/S. BRILLIANT INSTITUTE OF ENGINEERING & TECHNOLOGY**
 2) **M/S. KASIREDDY NARAYAN REDDY COLLEGE OF ENGINEERING & RESEARCH**
 3) **M/S. BRILLIANT GRAMMAR SCHOOL EDUCATIONAL SOCIETY'S GROUP OF INSTITUTIONS - INTEGRATED CAMPUS**

REPRESENTED BY ITS SECRETARY: **K. NARAYAN REDDY**

1) **M/S. BRILLIANT INSTITUTE OF ENGINEERING & TECHNOLOGY**
 EXISTING GROUND FLOOR SLAB AREA : 4928.72 sq.mt
 EXISTING FIRST FLOOR SLAB AREA : 4342.14 sq.mt
 EXISTING SECOND FLOOR SLAB AREA : 4342.14 sq.mt
 EXISTING THIRD FLOOR SLAB AREA : 4342.14 sq.mt
 EXISTING FOURTH FLOOR SLAB AREA : 4342.14 sq.mt
 TOTAL BUILT UP AREA : 22,297.28 sq.mt

2) **M/S. KASIREDDY NARAYAN REDDY COLLEGE OF ENGINEERING & RESEARCH - (BLOCK-1)**
 EXISTING GROUND FLOOR SLAB AREA : 2959.60 sq.mt
 EXISTING FIRST FLOOR SLAB AREA : 2959.60 sq.mt
 EXISTING SECOND FLOOR SLAB AREA : 2959.60 sq.mt
 EXISTING THIRD FLOOR SLAB AREA : 2959.60 sq.mt
 EXISTING FOURTH FLOOR SLAB AREA : 2959.60 sq.mt
 TOTAL BUILT UP AREA : 14,798.00 sq.mt

3) **M/S. KASIREDDY NARAYAN REDDY COLLEGE OF ENGINEERING & RESEARCH - (BLOCK-2)**
 EXISTING GROUND FLOOR SLAB AREA : 1013.15 sq.mt
 EXISTING FIRST FLOOR SLAB AREA : 1013.15 sq.mt
 EXISTING SECOND FLOOR SLAB AREA : 1013.15 sq.mt
 EXISTING THIRD FLOOR SLAB AREA : 1013.15 sq.mt
 EXISTING FOURTH FLOOR SLAB AREA : 1013.15 sq.mt
 TOTAL BUILT UP AREA : 5065.75 sq.mt

4) **M/S. BRILLIANT GRAMMAR SCHOOL EDUCATIONAL SOCIETY'S GROUP OF INSTITUTIONS - INTEGRATED CAMPUS (ENGINEERING) - BLOCK-1**
 EXISTING GROUND FLOOR SLAB AREA : 2812.85 sq.mt
 EXISTING FIRST FLOOR SLAB AREA : 2812.85 sq.mt
 EXISTING SECOND FLOOR SLAB AREA : 2812.85 sq.mt
 EXISTING THIRD FLOOR SLAB AREA : 2812.85 sq.mt
 EXISTING FOURTH FLOOR SLAB AREA : 2812.85 sq.mt
 TOTAL BUILT UP AREA : 14084.25 sq.mt

5) **M/S. BRILLIANT GRAMMAR SCHOOL EDUCATIONAL SOCIETY'S GROUP OF INSTITUTIONS - INTEGRATED CAMPUS (PHARMACY) - BLOCK-2**
 EXISTING GROUND FLOOR SLAB AREA : 1162.03 sq.mt
 EXISTING FIRST FLOOR SLAB AREA : 1162.03 sq.mt
 EXISTING SECOND FLOOR SLAB AREA : 1162.03 sq.mt
 EXISTING THIRD FLOOR SLAB AREA : 1162.03 sq.mt
 EXISTING FOURTH FLOOR SLAB AREA : 1162.03 sq.mt
 TOTAL BUILT UP AREA : 5810.15 sq.mt

TOTAL BUILT UP AREA : 62035.43 sq.mt